

**Application for a premises licence to be granted  
under the Licensing Act 2003**

**PLEASE READ THE FOLLOWING INSTRUCTIONS FIRST**

Before completing this form please read the guidance notes at the end of the form.  
If you are completing this form by hand please write legibly in block capitals. In all cases ensure that your answers are inside the boxes and written in black ink. Use additional sheets if necessary.

You may wish to keep a copy of the completed form for your records.

I/We **NURCAN COSKUN**

*(Insert name(s) of applicant)*

apply for a premises licence under section 17 of the Licensing Act 2003 for the premises described in Part 1 below (the premises) and I/we are making this application to you as the relevant licensing authority in accordance with section 12 of the Licensing Act 2003

**Part 1 – Premises Details**

<b>Postal address of premises or, if none, ordnance survey map reference or description</b>			
295 HIGH ROAD			
LOUGHTON			
<b>Post town</b>	ESSEX	<b>Post code</b>	IG10 1AL

<b>Telephone number at premises (if any)</b>	
<b>Non-domestic rateable value of premises</b>	£29750

**Part 2 - Applicant Details**

Please state whether you are applying for a premises licence as  
Please tick yes

- a) an individual or individuals \*  please complete section (A)
- b) a person other than an individual \*
  - i. as a limited company  please complete section (B)
  - ii. as a partnership  please complete section (B)
  - iii. as an unincorporated association or  please complete section (B)
  - iv. other (for example a statutory corporation)  please complete section (B)
- c) a recognised club  please complete section (B)
- d) a charity  please complete section (B)

- e) the proprietor of an educational establishment  please complete section (B)
- f) a health service body  please complete section (B)
- g) a person who is registered under Part 2 of the Care Standards Act 2000 (c14) in respect of an independent hospital  please complete section (B)
- h) the chief officer of police of a police force in England and Wales  please complete section (B)

\* If you are applying as a person described in (a) or (b) please confirm:

Please tick yes

- I am carrying on or proposing to carry on a business which involves the use of the premises for licensable activities; or
- I am making the application pursuant to a
  - statutory function or
  - a function discharged by virtue of Her Majesty's prerogative

**(A) INDIVIDUAL APPLICANTS (fill in as applicable)**

Mr <input type="checkbox"/>	Mrs <input checked="" type="checkbox"/>	Miss <input type="checkbox"/>	Ms <input type="checkbox"/>	Other Title (for example, Rev)	
<b>Surname</b> COSKUN			<b>First names</b> NURCAN		
I am 18 years old or over				<input checked="" type="checkbox"/> Please tick yes	
<b>Current postal address if different from premises address</b>		HAMPTON ROAD CHINGFORD			
<b>Post Town</b>	LONDON			<b>Postcode</b>	
<b>Daytime contact telephone number</b>					
<b>E-mail address (optional)</b>					

**SECOND INDIVIDUAL APPLICANT (if applicable)**

Mr <input type="checkbox"/>	Mrs <input type="checkbox"/>	Miss <input type="checkbox"/>	Ms <input type="checkbox"/>	Other Title (for example, Rev)	
<b>Surname</b>			<b>First names</b>		
I am 18 years old or over				<input type="checkbox"/> Please tick yes	

Current postal address if different from premises address			
Post Town		Postcode	
Daytime contact telephone number			
E-mail address (optional)			

**(B) OTHER APPLICANTS**

Please provide name and registered address of applicant in full. Where appropriate please give any registered number. In the case of a partnership or other joint venture (other than a body corporate), please give the name and address of each party concerned.

Name
Address
Registered number (where applicable)
Description of applicant (for example, partnership, company, unincorporated association etc.)
Telephone number (if any)
E-mail address (optional)

**Part 3 Operating Schedule**

When do you want the premises licence to start?

Day		Month		Year	
2	1	8	0	6	2
1	1	1	3		

If you wish the licence to be valid only for a limited period, when do you want it to end?

Day		Month		Year	

Please give a general description of the premises (please read guidance note 1)  
CONVENIENCE STORE  
OFF LICENCE, GROCERIES & NEWSPAPERS

If 5,000 or more people are expected to attend the premises at any one time, please state the number expected to attend.

What licensable activities do you intend to carry on from the premises?

(Please see sections 1 and 14 of the Licensing Act 2003 and Schedules 1 and 2 to the Licensing Act 2003)

**Provision of regulated entertainment**

**Please tick yes**

- a) plays (if ticking yes, fill in box A)
- b) films (if ticking yes, fill in box B)
- c) indoor sporting events (if ticking yes, fill in box C)
- d) boxing or wrestling entertainment (if ticking yes, fill in box D)
- e) live music (if ticking yes, fill in box E)
- f) recorded music (if ticking yes, fill in box F)
- g) performances of dance (if ticking yes, fill in box G)
- h) anything of a similar description to that falling within (e), (f) or (g) (if ticking yes, fill in box H)

**Provision of entertainment facilities:**

- i) making music (if ticking yes, fill in box I)
- j) dancing (if ticking yes, fill in box J)
- k) entertainment of a similar description to that falling within (i) or (j) (if ticking yes, fill in box K)

**Provision of late night refreshment** (if ticking yes, fill in box L)

**Supply of alcohol** (if ticking yes, fill in box M)

In all cases complete boxes N, O and P

**A**

Plays Standard days and timings (please read guidance note 6)			Will the performance of a play take place indoors or outdoors or both – please tick (please read guidance note 2)	Indoors	<input type="checkbox"/>
Day	Start	Finish		Outdoors	<input type="checkbox"/>
Mon			<b>Please give further details here</b> (please read guidance note 3)	Both	<input type="checkbox"/>
Tue					
Wed			<b>State any seasonal variations for performing plays</b> (please read guidance note 4).		
Thur					
Fri			<b>Non standard timings. Where you intend to use the premises for the performance of plays at different times to those listed in the column on the left, please list</b> (please read guidance note 5)		
Sat					
Sun					

**B**

<b>Films</b> Standard days and timings (please read guidance note 6)			<b>Will the exhibition of films take place indoors or outdoors or both – please tick</b> (please read guidance note 2)	Indoors	<input type="checkbox"/>
				Outdoors	<input type="checkbox"/>
				Both	<input type="checkbox"/>
<b>Day</b>	<b>Start</b>	<b>Finish</b>			
Mon			<b>Please give further details here</b> (please read guidance note 3)		
Tue					
Wed			<b>State any seasonal variations for the exhibition of films</b> (please read guidance note 4)		
Thur					
Friday			<b>Non standard timings. Where you intend to use the premises for the exhibition of films at different times to those listed in the column on the left, please list</b> (please read guidance note 5)		
Sat					
Sun					

C

Indoor sporting events Standard days and timings (please read guidance note 6)			Please give further details (please read guidance note 3)
Day	Start	Finish	
Mon			
Tue			<b>State any seasonal variations for indoor sporting events</b> (please read guidance note 4)
Wed			
Thur			<b>Non standard timings. Where you intend to use the premises for indoor sporting events at different times to those listed in the column on the left, please list</b> (please read guidance note 5)
Fri			
Sat			
Sun			

D

<b>Boxing or wrestling entertainments</b> Standard days and timings (please read guidance note 6)			<b>Will the boxing or wrestling entertainment take place indoors or outdoors or both – please tick</b> (please read guidance note 2)	Indoors	<input type="checkbox"/>
				Outdoors	<input type="checkbox"/>
				Both	<input type="checkbox"/>
Day	Start	Finish	<b>Please give further details here</b> (please read guidance note 3)		
Mon					
Tue			<b>State any seasonal variations for boxing or wrestling entertainment</b> (please read guidance note 4)		
Wed					
Thur			<b>Non standard timings. Where you intend to use the premises for boxing or wrestling entertainment at different times to those listed in the column on the left, please list</b> (please read guidance note 5)		
Fri					
Sat					
Sun					



E

<b>Live music</b> Standard days and timings (please read guidance note 6)			<b>Will the performance of live music take place indoors or outdoors or both – please tick</b> (please read guidance note 2)	Indoors	<input type="checkbox"/>
				Outdoors	<input type="checkbox"/>
				Both	<input type="checkbox"/>
<b>Day</b>	<b>Start</b>	<b>Finish</b>	<b>Please give further details here</b> (please read guidance note 3)		
Mon					
Tue			<b>State any seasonal variations for the performance of live music</b> (please read guidance note 4)		
Wed					
Thur			<b>Non standard timings. Where you intend to use the premises for the performance of live music at different times to those listed in the column on the left, please list</b> (please read guidance note 5)		
Fri					
Sat					
Sun					

F

Recorded music Standard days and timings (please read guidance note 6)			Will the playing of recorded music take place <u>indoors or outdoors or both – please tick</u> (please read guidance note 2)	Indoors	<input type="checkbox"/>
Day	Start	Finish		Outdoors	<input type="checkbox"/>
Mon			<b>Please give further details here</b> (please read guidance note 3)	Both	<input type="checkbox"/>
Tue					
Wed			<b>State any seasonal variations for the playing of recorded music</b> (please read guidance note 4)		
Thur					
Fri			<b>Non standard timings. Where you intend to use the premises for the playing of recorded music at different times to those listed in the column on the left, please list</b> (please read guidance note 5)		
Sat					
Sun					

**G**

<b>Performances of dance</b> Standard days and timings (please read guidance note 6)			<b>Will the performance of dance take place indoors or outdoors or both – please tick</b> (please read guidance note 2)	Indoors	<input type="checkbox"/>
				Outdoors	<input type="checkbox"/>
				Both	<input type="checkbox"/>
<b>Day</b>	<b>Start</b>	<b>Finish</b>	<b>Please give further details here</b> (please read guidance note 3)		
Mon					
Tue			<b>State any seasonal variations for the performance of dance</b> (please read guidance note 4)		
Wed					
Thur					
Fri			<b>Non standard timings. Where you intend to use the premises for the performance of dance at different times to those listed in the column on the left, please list</b> (please read guidance note 5)		
Sat					
Sun					

H

<p>Anything of a similar description to that falling within (e), (f) or (g) Standard days and timings (please read guidance note 6)</p>			<p><u>Please give a description of the type of entertainment you will be providing</u></p>		
Day	Start	Finish	<p><u>Will this entertainment take place indoors or outdoors or both – please tick</u> (please read guidance note 2)</p>	Indoors	<input type="checkbox"/>
Mon				Outdoors	<input type="checkbox"/>
				Both	<input type="checkbox"/>
Tue			<p><u>Please give further details here</u> (please read guidance note 3)</p>		
Wed					
Thur			<p><u>State any seasonal variations for entertainment of a similar description to that falling within (e), (f) or (g)</u> (please read guidance note 4)</p>		
Fri					
Sat			<p><u>Non standard timings. Where you intend to use the premises for the entertainment of a similar description to that falling within (e), (f) or (g) at different times to those listed in the column on the left, please list</u> (please read guidance note 5)</p>		
Sun					

<b>Provision of facilities for making music</b> Standard days and timings (please read guidance note 6)			<b><u>Please give a description of the facilities for making music you will be providing</u></b>		
			<b><u>Will the facilities for making music be indoors or outdoors or both – please tick</u></b> (please read guidance note 2)		Indoors <input type="checkbox"/> Outdoors <input type="checkbox"/> Both <input type="checkbox"/>
<b>Day</b>	<b>Start</b>	<b>Finish</b>	<b><u>Please give further details here</u></b> (please read guidance note 3)		
Mon					
Tue			<b><u>State any seasonal variations for the provision of facilities for making music</u></b> (please read guidance note 4)		
Wed					
Thur			<b><u>Non-standard timings: Where you intend to use the premises for provision of facilities for making music at different times to those listed in the column on the left, please list</u></b> (please read guidance note 5)		
Fri					
Sat					
Sun					

J

<b>Provision of facilities for dancing</b> Standard days and timings (please read guidance note 6)			<b>Will the facilities for dancing be indoors or outdoors or both – please tick (see guidance note 2)</b>	Indoors <input type="checkbox"/>
				Outdoors <input type="checkbox"/>
				Both <input type="checkbox"/>
<b>Day</b>	<b>Start</b>	<b>Finish</b>	<b>Please give a description of the facilities for dancing you will be providing</b>	
Mon			<b>Please give further details here (please read guidance note 3)</b>	
Tue				
Wed				
Thur			<b>State any seasonal variations for providing dancing facilities (please read guidance note 4)</b>	
Fri			<b>Non standard timings. Where you intend to use the premises for the provision of facilities for dancing entertainment at different times to those listed in the column on the left, please list (please read guidance note 5)</b>	
Sat				
Sun				

K

<b>Provision of facilities for entertainment of a similar description to that falling within i or j</b> Standard days and timings (please read guidance note 6)			<b><u>Please give a description of the type of entertainment facility you will be providing</u></b>		
Day	Start	Finish	<b><u>Will the entertainment facility be indoors or outdoors or both – please tick</u></b> (please read guidance note 2)	Indoors	<input type="checkbox"/>
Mon				Outdoors	<input type="checkbox"/>
				Both	<input type="checkbox"/>
Tue			<b><u>Please give further details here</u></b> (please read guidance note 3)		
Wed					
Thur					
Fri			<b><u>State any seasonal variations for the provision of facilities for entertainment of a similar description to that falling within i or j</u></b> (please read guidance note 4)		
Sat					
Sun					
			<b><u>Non standard timings. Where you intend to use the premises for the provision of facilities for entertainment of a similar description to that falling within i or j at different times to those listed in the column on the left, please list</u></b> (please read guidance note 5)		

L

<b>Late night refreshment Standard days and timings (please read guidance note 6)</b>			<b>Will the provision of late night refreshment take place indoors or outdoors or both – please tick (please read guidance note 2)</b>	Indoors	<input type="checkbox"/>
				Outdoors	<input type="checkbox"/>
				Both	<input type="checkbox"/>
<b>Day</b>	<b>Start</b>	<b>Finish</b>			
Mon			<b>Please give further details here (please read guidance note 3)</b>		
Tue					
Wed			<b>State any seasonal variations for the provision of late night refreshment (please read guidance note 4)</b>		
Thur					
Fri			<b>Non standard timings. Where you intend to use the premises for the provision of late night refreshment at different times, to those listed in the column on the left, please list (please read guidance note 5)</b>		
Sat					
Sun					



M

<b>Supply of alcohol</b> Standard days and timings (please read guidance note 6)			<b>Will the supply of alcohol be for consumption (Please tick box)</b> (please read guidance note 7)	On the premises	<input type="checkbox"/>
				Off the premises	<input checked="" type="checkbox"/>
				Both	<input type="checkbox"/>
<b>Day</b>	<b>Start</b>	<b>Finish</b>	<b>State any seasonal variations for the supply of alcohol</b> (please read guidance note 4)		
Mon	07.00	01.00			
Tue	07.00	01.00			
Wed	07.00	01.00			
Thur	07.00	01.00			
Fri	07.00	01.00			
Sat	07.00	01.00			
Sun	07.00	01.00			
			<b>Non standard timings. Where you intend to use the premises for the supply of alcohol at different times to those listed in the column on the left, please list</b> (please read guidance note 5)		

State the name and details of the individual whom you wish to specify on the licence as premises supervisor

<b>Name</b> HAYDAR GULTEKIN	
<b>Address</b>	
<b>Postcode</b>	
<b>Personal Licence number (if known)</b>	
<b>Issuing licensing authority (if known)</b> WALTHAM FOREST COUNCIL	

N

**Please highlight any adult entertainment or services, activities, other entertainment or matters ancillary to the use of the premises that may give rise to concern in respect of children (please read guidance note 8)**

NONE

**Hours premises are open to the public Standard days and timings (please read guidance note 6)**

Day	Start	Finish
Mon	07.00	01.00
Tue	07.00	01.00
Wed	07.00	01.00
Thur	07.00	01.00
Fri	07.00	01.00
Sat	07.00	01.00
Sun	07.00	01.00

**State any seasonal variations (please read guidance note 4)**

**Non standard timings. Where you intend the premises to be open to the public at different times from those listed in the column on the left, please list (please read guidance note 5)**

**P** Describe the steps you intend to take to promote the four licensing objectives:

**a) General – all four licensing objectives (b,c,d,e) (please read guidance note 9)**

All staff making sales of alcohol must be a Personal Licence holder or trained and authorised in writing by the Designated Premises Supervisor.

**b) The prevention of crime and disorder**

A digital Closed Circuit Television System will be installed and maintained on the premises. The CCTV system will be recording at all times when the premises are open and the recordings shall be kept for 31 days and made available to the police and the council on request.

**c) Public safety**

Fire safety equipment will be checked regularly and any requirements made by the Fire Safety Officer will be complied with.

**d) The prevention of public nuisance**

Signs will be displayed at the exit reminding customers to leave quietly and respect the neighbours.

**e) The protection of children from harm**

All staff will be trained that alcohol will only be sold to persons who can produce photographic identification where there is any doubt that they are over the age of 18.

All persons who appear to be under 25 will be challenged to produce photographic identification.

A Refusal Book will be maintained and available for inspection by the Police or the Council officers upon request.

Please tick yes

- I have made or enclosed payment of the fee
- I have enclosed the plan of the premises
- I have sent copies of this application and the plan to responsible authorities and others where applicable
- I have enclosed the consent form completed by the individual I wish to be premises supervisor, if applicable
- I understand that I must now advertise my application
- I understand that if I do not comply with the above requirements my application will be rejected

**IT IS AN OFFENCE, LIABLE ON CONVICTION TO A FINE UP TO LEVEL 5 ON THE STANDARD SCALE, UNDER SECTION 158 OF THE LICENSING ACT 2003 TO MAKE A FALSE STATEMENT IN OR IN CONNECTION WITH THIS APPLICATION**

**Part 4 – Signatures (please read guidance note 10)**

**Signature of applicant or applicant’s solicitor or other duly authorised agent (See guidance note 11). If signing on behalf of the applicant please state in what capacity.**

Signature	
Date	28 <sup>th</sup> May 2013
Capacity	AUTHORISED AGENT

**For joint applications signature of 2<sup>nd</sup> applicant or 2<sup>nd</sup> applicant’s solicitor or other authorised agent. (please read guidance note 12). If signing on behalf of the applicant please state in what capacity.**

Signature	
Date	
Capacity	

**Contact name (where not previously given) and postal address for correspondence associated with this application (please read guidance note 13)**

J & H LICENSING CONSULTANTS  
35 WALFIELD AVENUE  
WHETSTONE

**Post town** LONDON **Post code** N20 9PS

**Telephone number (if any)** 0208 446 8643

**If you would prefer us to correspond with you by e-mail your e-mail address (optional)**  
trev.jenny@btinternet.com

**Consent of individual to being specified as premises supervisor**

HAYDAR GULTEKIN

I

-----  
*[full name of prospective premises supervisor]*

of

CHINGFORD

LONDON

-----  
*[home address of prospective premises supervisor]*

hereby confirm that I give my consent to be specified as the designated premises supervisor in relation to the application for

GRANT OF PREMISES LICENCE

-----  
*[type of application]*

by

NURCAN COSKUN

-----  
*[name of applicant]*

relating to a premises licence

-----  
*[number of existing licence, if any]*

for

295 HIGH ROAD

LOUGHTON

ESSEX

IG10 1AL

-----  
*[name and address of premises to which the application relates]*

and any premises licence to be granted or varied in respect of this application made by

NURCAN COSKUN

-----  
*[name of applicant]*

concerning the supply of alcohol at

295 HIGH ROAD

LOUGHTON

ESSEX

IG10 1AL

-----  
*[name and address of premises to which application relates]*

I also confirm that I am applying for, intend to apply for or currently hold a personal licence, details of which I set out below.

Personal licence number

-----  
*[insert personal licence number, if any]*

Personal licence issuing authority

WALTHAM FOREST COUNCIL, SYCAMORE HOUSE, WALTHAM FOREST  
TOWN HALL, FOREST ROAD, WALTHAMSTOW, LONDON E17 4JF  
0208 496 2247

-----  
*[insert name and address and telephone number of personal licence issuing authority, if any]*

Signed

Name (please print)

-----  
HAYDAR GULTEKIN  
-----

Date

-----  
23/5/13  
-----

# GROUND FLOOR SHOP PREMISES

295 High Road  
Loughton  
Essex  
IG10 1AL

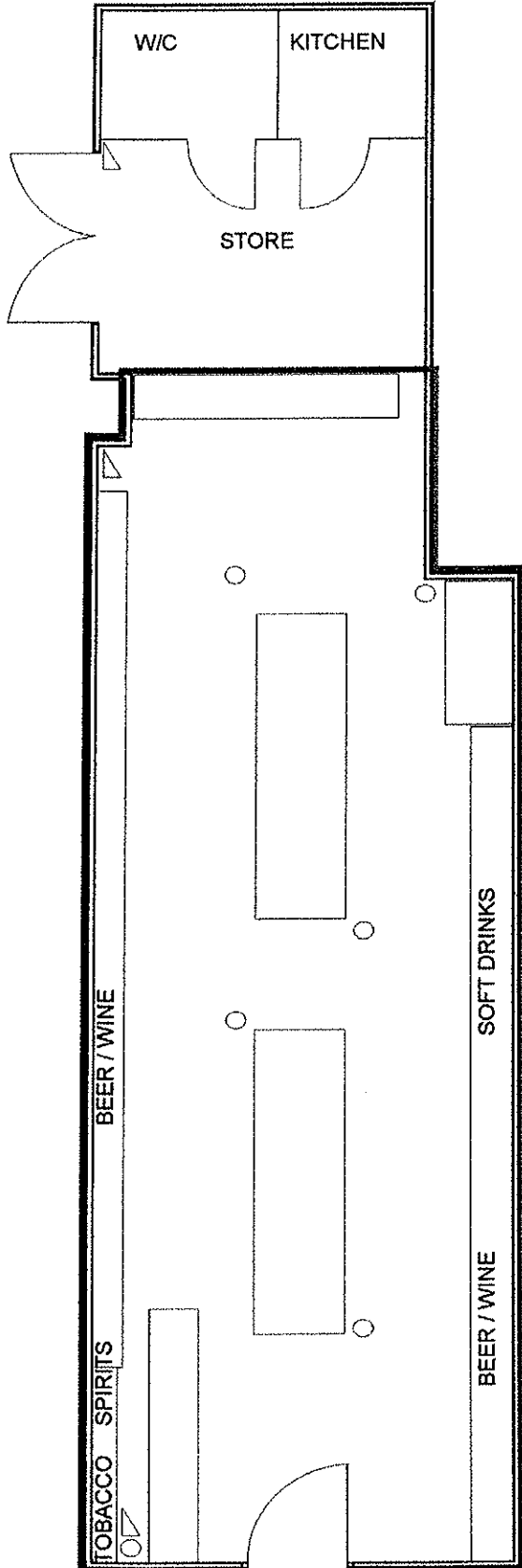

-  FIRE EXTINGUISHER
-  CCTV
-  ALCOHOL SALES

Date:  
May 2013

Scale:  
1:100

Drawings by:  
IMPERIAL PLANS  
IMPERIAL COURT  
1028 HIGH ROAD  
LONDON N20 0QW

Rubbish Clearance

**RUBBISH CLEARANCE**  
 • LOWEST PRICES  
 • FREE ESTIMATES • RUBBISH REMOVAL

020 8520 7390  
 07 957 123019

**WE ARE RUBBISH**  
 Reliable Day Service  
 Cheapest Rates  
 Call Today on  
 020 8520 7390  
 07 957 123019

Skip Hire

**HUNT SKIPS**  
 Fast, Reliable Service  
 Excellent Rates  
 020 8807 5948

**TOWN SKIPS**  
 EXCELLENT SERVICE  
 ALL TYPES OF SKIPS  
 020 8887 6867  
 www.townskips.co.uk

**A & A SKIP HIRE**  
 All skips available  
 Friendly, reliable service.  
 Tel: 020 8529 6902  
 07966 433791  
 www.eastfordonskiphire.com

Tiling Services

**WALL/FLOOR TILING**  
 Kitchens, Bathrooms, Conservatories. Quality work reliable tradesman. 020 8529 0253, 07890 473085

There's no substitute for experience  
 Your local **Guardian**  
 Established over 130 years  
 To advertise telephone our display team on  
**0844 499 3118**  
 guardian-series.co.uk

Chatlines

**366P CHEAP SEX**  
 LIVE XXX RELAX & PLAY  
 0909 864 1063

**GRANNY DOES IT REAL**  
**366 FILTHY PHONE SEX**  
 0909 864 9712

Over **144,000** people could be looking at your advert online!  
\*source: Omniture Sept 2010

Find out how you can be seen on **guardian-series.co.uk**  
 020 8884 7425  
 sellert@london.newsquest.co.uk

# Gardener's Plot

Fencing Services

**ESSEX FENCING**  
 Top quality fencing materials  
 Supply & installation of all types of fencing  
 For a free quote call us on  
 01709 793100 • 240245  
 Office: 01709 793100  
 240245 • essexfencing.com

Gardening Maintenance

**Garden Service Ltd**  
 Garden Creators  
 Patios, Decking, Brick walls, Turf  
 Fences, Driveways, Tidy ups  
 Call 020 3174 1619  
 Or Freephone 0800 232 1877  
 Or Paul on 07980 390 824  
 www.gardenservice.co.uk

Gardening Maintenance

**TAYLOR TREE CARE**  
 All Types of Trees Expertly  
 • Felled • Planted • Shaped  
 • Stumps Ground Out  
 • Overgrown Gardens Cleared • Fencing  
 Free Quotes  
 0208 485 9279  
 07769 313 080

**KV GARDENING SERVICES**  
 Ride on mower to large gardens  
 Fully licensed waste carrier  
 Full Garden Maintenance Service  
 Client References available  
 Contact Beau 07947 807900  
 After 6pm 020 8498 0592  
 www.gardeningkv.co.uk

BOWSON'S

All tree & garden work undertaken  
 Same Day Service  
 30 years experience  
**07572740919**

**GRASS CUTTING**, hedge trimming & all garden work undertaken. Call 07779 563 214

Ads240

www.guardian-series.co.uk

WF

guardian-series.co.uk

Let us help you put the pieces together

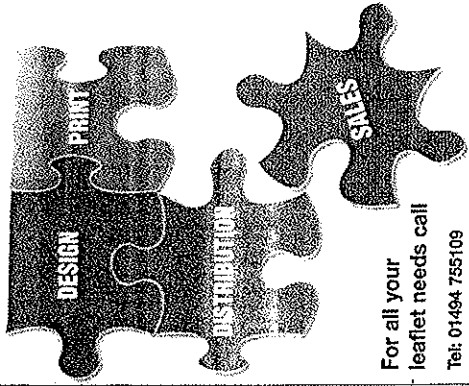

For all your leaflet needs call  
Tel: 01494 755109  
Fax: 01494 755165  
letterbox@london.newsquest.co.uk



Public Notices

**LICENSING ACT 2003  
 NOTICE OF APPLICATION FOR THE GRANT OF A PREMISES LICENCE**

Notice is hereby given that NURCAN COSKUN has applied to the Licensing Authority of Epping Forest District Council for the GRANT of a Premises Licence to permit THE SALE BY RETAIL OF ALCOHOL BETWEEN 07.00 AND 01.00 FOLLOWING EVERY DAY for the premises situated at 295 HIGH ROAD, LOUGHTON, ESSEX IG10 1AL. A register of licensing applications can be inspected during office hours at the Licensing Office of Epping Forest District Council, Civic Offices, High Street, Epping, Essex CM16 4EZ or www.eppingforestdc.gov.uk. Any person wishing to submit relevant representations concerning this application must give notice in writing to The Licensing Officer giving in detail the grounds of the representation no later than: 27th day of June 2013. Representations must relate to one or more of the four Licensing Objectives: the prevention of crime and disorder, public safety, the prevention of public nuisance and the protection of children from harm. It is an offence liable on conviction to a fine up to £5000 under section 158 of the Licensing Act 2003 knowingly or recklessly to make a false statement in connection with an application.  
 Dated this 28th day of May 2013  
 Signed J & H Licensing Consultants - Authorised Agents

# Your local Guardian



guardian-series.co.uk



ESSEX POLICE



Licensing Department, Epping Police Station  
230 High Street, Epping, CM16 4AP  
Telephone 01279 625 405 Facsimile: 01279 625 440  
Website: [www.essex.police.uk](http://www.essex.police.uk) Email: [Peter.Jones@essex.pnn.police.uk](mailto:Peter.Jones@essex.pnn.police.uk)

Mrs Kim Tuckey  
Licensing Department  
Epping Forest District Council  
Civic Offices  
High Street  
Epping  
CM16 4BZ

4 June 2013

Dear Kim,

**LICENSING ACT 2003 – GRANT OF PREMISES LICENCE SECTION 17**

**NEW PREMISE: 295 High Road, Loughton**

**DPS: Haydar Gultekin**

**APPLICANT: Nurcan Coskun via J & H Licensing Consultants**

Further to the above application for the Grant of a Premises Licence received on 29 May 2013, I write to inform you that Essex Police will be making representations for the following reasons:

The proposed premises are in a busy High Road with residential dwellings in close proximity, including above. It is also in close proximity to public houses with earlier closing times. As such, their patrons may continue to the proposed premises whilst already intoxicated. The noise that these and other customers can cause would be a disturbance to residents. Essex Police feel the proposed operating hours would cause an increase in Public Nuisance, and possible Crime and Disorder. For these reasons, Essex Police propose the hours should be amended to 0800-2300 Monday to Sunday.

Please advise me of when the Licensing Panel will be meeting to hear this so I can be in attendance.

Yours sincerely,

Mr Peter Jones ABII  
Epping & Brentwood Licensing Officer  
West LPA

## Sarah Kits

---

**From:** Peter Jones <Peter.Jones@essex.pnn.police.uk>  
**Sent:** 10 June 2013 13:15  
**To:** Jenny Hughes  
**Cc:** Sarah Kits  
**Subject:** RE: Premises Licence Application - 295 High Road, Loughton [NOT PROTECTIVELY MARKED]  
**Attachments:** 295 High Road, Loughton - Premises New - Representations.pdf

Dear All,

Apologies but due to illness last week, the actual objection letter was typed Tuesday, but didn't get sent. It is attached.

However, as a result of the email below confirming the applicants agreement to the amended licensable times, it is withdrawn.

Many Thanks

### *Peter Jones ABII (7706)*

Epping & Brentwood Licensing Officer  
West LPA

 Tel. 01279 625405 or 101 (Ext. 318175)

 Fax. 01279 625440 (Int. 318335)

 [Peter.Jones@essex.pnn.police.uk](mailto:Peter.Jones@essex.pnn.police.uk)

 [www.essex.police.uk](http://www.essex.police.uk)

 Epping Police Station  
230 High Street  
Epping  
CM16 4AP

To find out what is happening in your neighbourhood and all about your local neighbourhood policing team visit [www.essex.police.uk/yourarea](http://www.essex.police.uk/yourarea) and enter your postcode.

---

**From:** Jenny Hughes [mailto:trev.jenny@btinternet.com]  
**Sent:** 06 June 2013 21:51  
**To:** Peter Jones  
**Cc:** skits@eppingforestdc.gov.uk  
**Subject:** Re: Premises Licence Application - 295 High Road, Loughton [NOT PROTECTIVELY MARKED]  
**Importance:** High

Mr Jones

Thank you for your reply.

We have taken further instructions from our client and can confirm that he is willing to amend his application to permit the sale of alcohol between 08.00 and 23.00 daily provided you withdraw any objection.

Jenny Hughes  
J & H Licensing Consultants

Our Ref: L.1.1/VRM

Ms Sarah Kits  
Licensing Section  
Epping Forest District Council  
Civic Offices  
Epping  
CM16 4BZ  
(Emailed: [skits@eppingforestdc.gcsx.gov.uk](mailto:skits@eppingforestdc.gcsx.gov.uk))

19 June 2013



**LOUGHTON**  
TOWN COUNCIL

1 Buckingham Court, Rectory Lane  
Loughton, Essex IG10 2QZ  
Telephone: 020 8508 4200  
Facsimile: 020 8508 4400  
e-mail: [contact@loughton-tc.gov.uk](mailto:contact@loughton-tc.gov.uk)  
Web site: [www.loughton-tc.gov.uk](http://www.loughton-tc.gov.uk)  
Town Clerk: Enid K Walsh

e-mail: [vivienne.messenger@loughton-tc.gov.uk](mailto:vivienne.messenger@loughton-tc.gov.uk)  
ext 207

Dear Ms Kits

**Re: Notice of application for a premises licence under the Licensing Act 2003 in respect of 295 High Road, Loughton IG10 1AL**

Members present at the Planning and Licensing Committee meeting on 17 June 2013, made the following representation, as an interested party.

The Committee had NO OBJECTION to this licensing application provided the revised times for the sale of alcohol were from Monday to Sunday between the hours of 08.00 to 23.00 only. Curtailing the sale of alcohol to 11pm would be more likely to meet the four licensing objectives – the prevention of crime and disorder, public safety, the prevention of public nuisance, and protection of children from harm.

I would be grateful if you can acknowledge receipt of this letter and let me know whether it will go to the Licensing Sub-Committee or be dealt with by officers.

Yours sincerely

Vivienne Messenger  
Planning Committee Clerk

The Licensing Team  
Epping Forest District Council,  
Civic Offices,  
High Street,  
Epping, Essex  
CM16 4BZ

Mrs. C. Edwards  
High Road  
Loughton.  
Essex.

20-6-13.

To the Senior Licensing Officer

I understand that an application has been made by Mr Nurcan Coskun to sell alcohol between the hours of 7am – 1am at the premises underneath my home.

I strongly appeal this application;

The sale of alcohol between these hours will in turn increase anti-social behaviour very close to my home. We have an easily accessible car park behind our flats, which customers of this off license will use to park, congregate, drink, and make public nuisance.

I have a dog, which I walk early in the morning and late at night- I would not be able to do this, for fear of my safety- walking in and out of my building, where lighting and security is not present.

I have a young child, and would not be able to let him out in the near areas of my front door to play for fear of drunks or antisocial behaviour affecting him or endangering him.

There are also several young children and babies who live in the flats nearby- which I know would be directly affected by the noises of cars pulling up in our slip road to the front, and our car park to the back.

From experience at the other end of Loughton High road, I know that youths and groups of drunken people spilling out from the Nu Bar congregate outside Baileys Off Licence. This would be exactly the case outside our building, with people looking for after-hours drinks after they have been at Bar 15, The Last Post, The Olive Tree- any number of the premises already selling alcohol until the early hours in Loughton.

Please inform me of any new information regarding this application

Regards,

Enc.

## Sarah Kits

---

**From:** Tony GOREHAM <tony.goreham@uk.bnpparibas.com>  
**Sent:** 10 June 2013 10:05  
**To:** Licensing  
**Cc:** tonygoreham@gmail.com  
**Subject:** strongly oppose

Good morning,

As the owner of flat no [redacted] High rd Loughton, we strongly oppose the proposed ' application in respect of premises licenses', this would be totally unacceptable.

The majority of the above flats have families/children in them and allowing a late license or in fact any license to sell alcohol would be appalling.

I cannot think of much worse, there are already shops that are open late, Baileys, there is no need for another unless the council wishes increase the likely hood of aggravation for the local community and police force.

Regards Tony Goreham.

---

This e-mail may contain confidential and/or privileged information. If you are not the intended recipient (or have received this e-mail in error) please notify the sender immediately and delete this e-mail. Any unauthorised copying, disclosure or distribution of the material in this e-mail is prohibited.

Please refer to <http://www.bnpparibas.co.uk/en/email-disclaimer/> for additional disclosures.

## Sarah Kits

---

**From:** Gregor Durston <Gregor.Durston@spacenk.com>  
**Sent:** 20 June 2013 14:29  
**To:** Licensing  
**Cc:** Gregor Durston  
**Subject:** Application WK/201314760

Dear Sirs,

**Re: 295 High Road, Loughton IG10 1AL:**

I refer to the above application for the above premises, the owners of which have applied for a licence allowing them to sell alcohol as part of their convenience store offer.

I wish to object to the granting of this licence on the following grounds.

1. Crime prevention: Space NK 291 High Road has experienced a number of costly break in attempts. The inclusion of a license to sell alcohol at the above location I feel with expose our premises to the possibility of increased criminal damage fuelled by alcohol.
2. Public nuisance: Noise and resulting disruption will be a by product of the sale of alcohol. This will be disruptive to the residents above and to our trade at certain times of the day.

Morrisons supermarket is opposite and sells alcohol. In addition there are numerous licensed premises within the immediate vicinity. I feel another licensed premises in unnecessary .

Regards,

Gregor Durston  
Property Manager  
Space NK Ltd

---

This email has been scanned by the Symantec Email Security.cloud service.  
For more information please visit <http://www.symanteccloud.com>

---